

UKL SIGHT GLASS

UKL offers Sight Glasses which enables the visualization of liquid in the pipeline. This helps in pre-empting problems occurring in the equipment upstream or downstream of the glass.

UKL Sight Glass consist of toughened Borosilicate glass, thermally pre stressed, optically tested.

UKL Sight Glass Double window type uses Klinger glasses for consistent, reliable, trouble free performance.

APPLICATIONS:-

UKL Sight Glass can be fitted on a condensate line to monitor steam leakages in the condensate because of the improved visibility it offers, UKL Sight Glass is especially suited for use in lines with high-speed flow.

The flow of oil and oil vapor can be visualized using sight glass. UKL Sight Glass for observation of processes in industrial ovens, driers, filters, strainers, agitators and mixers.

UKL Sight Glass can be used to check the efficiency of heat exchangers, especially in condensers, reboilers.

UKL Sight Glass can be installed in any direction.

Graphite/ CAF gaskets are used to avoid leakages.

OPERATING CONDITIONS:

Max Operating pressure - 40 kg/cm²
 Max Operating Temp. - 300 °C
 Cold Hydro test pressure - 60 kg/cm²

OPERATING CONDITIONS:

Max Operating pressure - 40 kg/cm²
 Max Operating Temp. - 300 °C
 Cold Hydro test pressure - 60 kg/cm²

Class	Temperature	38 °C
#150	Pressure	19.6
#300	(kg/cm ²)	40



INSTALLATION:-

Preferably in horizontal position.

OPTIONAL:-

IBR/Non-IBR
 Flanged End ANSI #150/#300

END CONNECTIONS:

Socket Weld to ASME B 16.11
 Screwed BSP / NPT / BSPT
 Flanged End as per BS 10, #150/ #300

MATERIAL OF CONSTRUCTION:

ASTMA 216 Gr. WCB

SIZES AVAILABLE:-

15NB, 20NB, 25NB, 40NB and 50 NB

Sight Glass USG

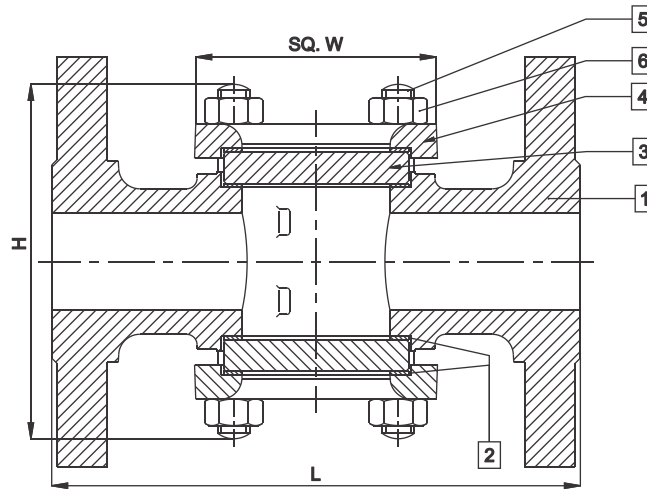

No.	PART NAME	MATERIAL	MATERIAL CODE
1	Body	Carbon Steel	ASTM A 216 Gr WCB
2	Gasket	Graphite Gasket With AISI316 Reinforcement	
3	Glass	Toughened Borosilicate Transparent Glass	
4	Cover	Carbon Steel	ASTM A 216 Gr WCB / ASTM A 515 Gr70 / ASTM A 516 Gr.70
5	Stud	Alloy Steel	ASTM 193 Gr. B7
6	Nut	Alloy Steel	ASTM 194 Gr. 2H

DIMENSIONS(mm) SW/Screwed and Flanged End					
Sr.	Size	L	H	SQ. W	Weight (kg)
1	15	130.00	101.00	56.00	2.1
2	20	130.00	104.00	66.00	2.2
3	25	160.00	110.00	71.00	2.8
4	40	200.00	134.00	91.00	7.0
5	50	230.00	159.00	101.00	7.7

Other Products :  Cast / Forged Steel Piston Valves, Bellow seal valves, High Pressure valves (Gate/Globe) , Strainers – “Y” Type, ITVS Steam Traps (Thermodynamic, Thermostatic, Ball Float Traps and IBT), Pressure Reducing Station, Condensate Recovery Products. Level Gauges (Reflex, Transparent, Bicolor), Sight Glass, Hot Water Generation System, Safety and Relief Valves.
FSD Products : Compressed Asbestos / Non Asbestos Fiber Sheeting / Cut Gaskets, Spiral Wound Gaskets / Gland Packing

In view of technical progress designs and dimensions are subject to change without notice.



UNI KLINGER LIMITED

A joint venture of the Neterwala group of companies and KLINGER AG, Switzerland.



HARSH ENGINEERING SALES & SERVICE PVT. LTD

Only Authorized Dealers for UNI KLINGER products, Telangana

Add: 2-3-692/22/13 Lal Bagh, Zinda Tillismath Road, Ganga Nagar, Amberpet, Hyderabad - 500013
Tel: +91-40-2740 3329 | Website: harsh-engineering.com | E-mail: sales@harsh-engineering.com